

boAt



CINEHEAD M1

Smart Projector

boAt

CINEHEAD M1

Thank you for choosing the boAt CineHead M1 as your personal home entertainment companion. We're thrilled to be part of your journey, whether it's a cosy movie night or a presentation that matters.

This user manual is designed to help you understand the setup, functions, and features of your projector. Read it thoroughly before first use to ensure a smooth sail. You can always refer back to these instructions whenever needed.

PACKAGE CONTENT

Carefully unpack and verify that you have all of the items mentioned below. The x with the number indicates the quantity of the component:

- 1x CineHead M1 Projector
- 1x Remote Control (batteries not included)
- 1x Power Cord
- 1x HDMI Cable
- 1x User Manual
- 1x Warranty Card
- 1x OTT Login Card
- 1x Quick Set-Up QR Card



1



2



3



4

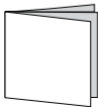

5



6



7



8

KEY FEATURES

- **Full HD 1080p Native Resolution:** Get a native resolution of 1080 pixels for high-definition video output.
- **LED Light Source:** Uses an LED light source, designed for longer lifespan and energy efficiency.
- **Auto Focus:** The projector automatically adjusts focus to ensure a clear and sharp image.
- **Automatic Keystone Correction:** Corrects image distortion for a rectangular display without manual adjustment.
- **Auto Focus :** Corrects image distortion for a rectangular display without manual adjustment.
- **Automatic Obstacle Avoidance:** Detects and adjusts the screen to avoid objects in the projection path.
- **Built-in Speakers:** Includes speaker rated at 6W (4Ω impedance).
- **Aspect Ratio Support:** Compatible with 16:9, 4:3, and Auto-fit aspect ratios.
- **Connectivity Ports:** Comes with the following input options:
 1. **USB x1:** Connect flash drives and compatible USB storage devices.
 2. **HDMI x1:** Interface with laptops, set-top boxes, or streaming devices.
- **Audio Output:** Includes an earphone output port for external audio devices.
- **Power Supply:** Supports 100V–240V AC input at 50/60Hz frequency.

REMOTE CONTROL

The remote control helps you use the projector easily. Here's what each button does:

1. **Power Button:** Turns the projector on or off.
2. **Mute Button:** Instantly mutes the sound.
3. **Focus Button:** Adjusts the focal distance to sharpen the image.

4. **Signal Source Button:** Lets you select between available input sources such as HDMI or USB.
5. **Return Button:** Takes you back to the previous screen or menu.
6. **Menu Button:** Opens the settings menu.
7. **Home Button:** Short press to return to the main home screen.
8. **Direction Button:** Use the Up, Down, Left, and Right arrows to navigate menus. Press the centre OK button to confirm selections.
9. **Volume Buttons (+ / -):** Press + to increase and – to decrease the volume level.

Note:

- Do not mix old and new batteries.
- Remove the batteries if the remote will not be used for a long time to prevent leakage and corrosion.

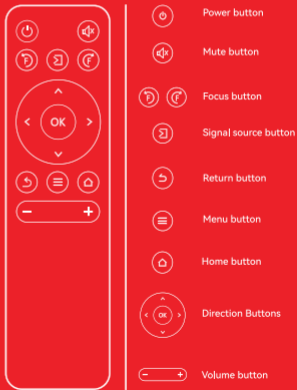

INSTALLING THE REMOTE CONTROL BATTERY

To power the remote control, you will need to insert two 1.5V AAA size dry batteries. Follow the steps below:

- 1. Locate the Arrow Mark:** Turn the remote control to its back. You will see a small arrow symbol near the bottom end of the battery compartment.
- 2. Remove the Battery Cover:** Gently lift the cover in the direction of the arrow to reveal the battery compartment.
- 3. Insert the Batteries:** Place two 1.5V AAA dry batteries inside the compartment. Ensure that the positive (+) and negative (-) ends of the batteries match the polarity markings inside the compartment.
- 4. Close the Battery Cover:** Slide the battery cover back into place until it clicks securely.

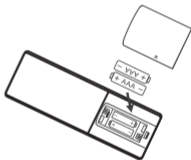
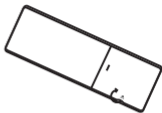

Remote Control Precautions

- If the remote control gets wet, wipe it dry immediately.
- Avoid excessive heat and humidity.
- Do not place the battery upside down.
- Replace only with the same or equivalent type recommended by the manufacturer.
- Dispose off used batteries according to your local regulations.

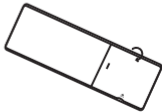

TURNING THE PROJECTOR ON/OFF

Power On:

1. Connect the power cable securely to the power inlet.
2. Plug the other end into a standard power outlet.
3. Press the Power button on the remote to turn the projector on. Alternatively, press the Power button on top of the projector.
4. Wait a few seconds for the projector to initialize and display the startup screen.

Power Off:

1. Press the Power button on the remote.
2. A pop-up will appear, select Power Off or Restart from the options.
3. Once the screen turns off completely, unplug the power cable if not using the projector for an extended period.

Note: Do not unplug the projector immediately after powering it off. Allow the shutdown and cooling cycle to complete to prevent overheating.

APPEARANCE & FUNCTION DESCRIPTION

The boAt CineHead M1 projector has multiple functional ports and buttons that are essential for operation and connectivity. Refer to the illustrations below for port locations and their respective functions

Top View

- **Power Button:** Press to turn the projector on or off.

Rear View

- **Power Input Port:** To connect the projector to a power source.
- **USB Port:** For connecting USB drives and other supported USB input devices.
- **HDMI Port:** Used for input from external video sources such as laptops, set-top boxes, or media players.
- **Headphone Port:** Standard 3.5 mm audio output for connecting earphones or external speakers.

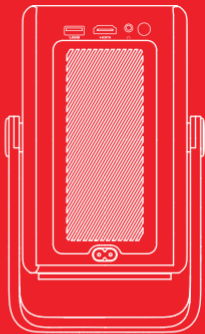

Power Input



USB



HDMI



Headphone



Power button

HARDWARE CONNECTIVITY INTERFACE

The projector supports USB and HDMI input for playing multimedia content or displaying output from other devices. Follow the instructions below for connecting and accessing each interface.

Connecting via USB Interface

1. Insert a USB drive into the USB port on the back of the projector.
2. After the drive is connected successfully, the system will display a USB connection icon on the top bar of the home screen.

3. You can browse the contents, including videos, images and audio, available in the USB drive.

Connecting via HDMI Interface

1. Plug the HDMI cable into the HDMI port on the projector and the output device (e.g., laptop)
2. From the home screen, select HDMI from the input source list.
3. The projector will switch to HDMI mode and display the output from the connected device.

Please ensure the connected device is powered on and set to output video via HDMI.

WIRELESS SCREEN MIRRORING

The boAt CineHead M1 supports wireless screen sharing for Android and iOS devices. Follow the instructions below to connect your smartphone to the projector wirelessly.

Step 1: Open Screen Mirroring Mode

- On the projector's home screen, select Screen Mirroring to access the MultiScreen interface.

Step 2: Select Connection Method Based on Your Device

- Choose the appropriate connection option depending on whether you're using an Android or iOS device.

For Android Devices (Miracast):

1. Turn on Wi-Fi on your Android phone (a Wi-Fi router connection is not necessary).
2. Open the wireless display feature (called "ScreenCast" "Wireless Display", "Cast", "Smart View", etc., depending on device brand).
3. From the list of available devices, select the projector name (e.g., "CineHead M1").
4. The device screen will start displaying on the projector once connected.

For iOS Devices (AirPlay):

1. Ensure both the projector and iOS device are connected to the same Wi-Fi network.
2. Open the Control Center on the iOS device and tap Screen Mirroring.
3. Choose the projector name "CineHead M1" from the list of available devices.
4. The screen will be mirrored onto the projector display once connected.

SETTINGS

Use the directional keys to navigate through the available options. Make sure to press OK to confirm selections and use the Return button to go back to the previous menu.

Wi-Fi Settings

Access Wi-Fi settings from the Settings > Wi-Fi.

- a. **Wi-Fi On/Off:** Toggle this option to turn ON or OFF Wi-Fi connectivity. When enabled, available networks will be displayed for selection.
- b. **Network Search:** Scans for nearby wireless devices and available networks.

Bluetooth Settings

Access Bluetooth settings from the Settings > Bluetooth menu.

- **Bluetooth on/off:** Toggle this option to turn on/off the Bluetooth. When Bluetooth is turned off, the projector will not be visible to other devices.
- **Scan for devices:** Use this option to search for available Bluetooth devices in range. Make sure that the external device is in pairing mode. Once detected, select the desired device from the list to pair.

Projection

Screen Focus

1. **Power On Auto Focus:** Toggle this setting to enable or disable auto focus each time the projector power on.
2. **Displacement Auto Focus:** This setting is always enabled by default. The projector automatically adjusts focus when it detects a change in position.
3. **Auto Focus:** Selecting this option will switch the screen to focus mode. The projector will automatically adjust the image sharpness for optimal clarity as shown in the figure.

Auto Focus Adjustment Interface

- When the projector is moved or repositioned, it will automatically adjust the focus.
 - A circular autofocus adjustment interface will appear on the screen during the adjustment process.
 - The image will sharpen automatically without requiring user input.
4. **Manual Focus:** Choose this option to adjust the focus manually. Use the Up, Down, Left, and Right arrow buttons on the remote control to set the focus based on your preference.

Auto Focus

Move the projector, and the following image will appear, that is, autofocus.

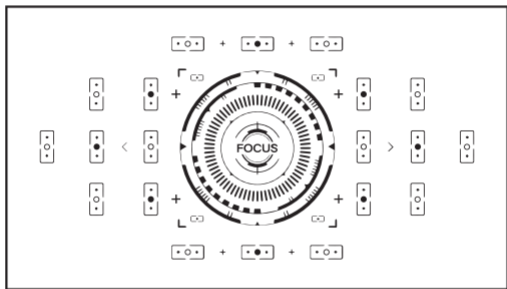

Digital Zoom

By default, the screen is set to 100% zoom, which represents the maximum display size. This setting allows you to zoom in or out on the projected screen.

- **Increase or Decrease Screen Size:** Use the Up and Down arrow buttons on the remote to increase or decrease screen size digitally.
- **Reset the Screen:** Press the Menu key on the remote to reset the screen to default display settings.

Keystone Correction

The boAt CineHead M1 projector offers both automatic and manual keystone correction to ensure that the projected image remains rectangular and distortion-free, even when the projector is not perfectly aligned with the screen.

1. **Power On Auto Keystone Correction:** Toggle this setting to enable or disable automatic keystone correction every time the projector is powered on.

2. **Displacement Auto Keystone Correction:** This setting is always active and automatically corrects the screen angle when the projector is moved or repositioned.

3. **Automatic Obstacle Avoidance:** Automatically detects and adjusts the image to avoid any objects on obstructions within the projection area.

4. **Automatic Screen Fit:** Automatically detects the screen area and adjusts the projection to fit within the visible screen or wall boundary.

5. **Auto Keystone Correction:** Manually trigger automatic keystone correction. The system will re-align the image to correct vertical or horizontal distortion.

- The projector uses a sensor to detect tilt and angle.
- When the projector is moved, a keystone calibration image (as shown in figure) will appear.
- The system automatically adjusts the vertical angle to ensure that the image is rectangular and properly aligned.

Auto keystone

Move the projector, and the following figure will appear, that is, in the automatic trapezoid.

(In the setting, auto focus and auto trapezoid are turned on at the same time, and only the auto trapezoid interface is displayed.)



Manual Keystone Correction: Allows you to manually fine-tune the corners the projection. Follow the steps mentioned below to perform manual keystone correction:

- Press the OK button on the remote to enter manual mode.
- Select any vertex (corner) of the projected image.
- Use the directional keys (Up/Down/Left/Right) to adjust the shape until the image appears proportionate and rectangular.

Electronic Focus using Remote

Alternatively, use the Focus F and E on the remote for focus adjustment if needed, you can manually fine-tune the image quality, as shown in the figure below.

Electronic focus

Press "F" and "E" to adjust the definition.



Intelligent Screen Correction

- When the projector is moved or repositioned, the Intelligent Screen Correction function automatically detects the screen's shape and position (refer to the figure).
- The system recalibrates the projection angle so that the image appears square, centered, and properly aligned.
- There is no need to manually adjust keystone or angle for most situations.
- As long as the projection surface is flat and the projector is within the supported distance and height, screen correction will activate automatically.

Note: This feature works best when the projector is placed on a stable surface and directly facing the screen or wall.

Intelligent Screen Correction

Move the device position,
the screen will be automatically adjusted to be square and clear.

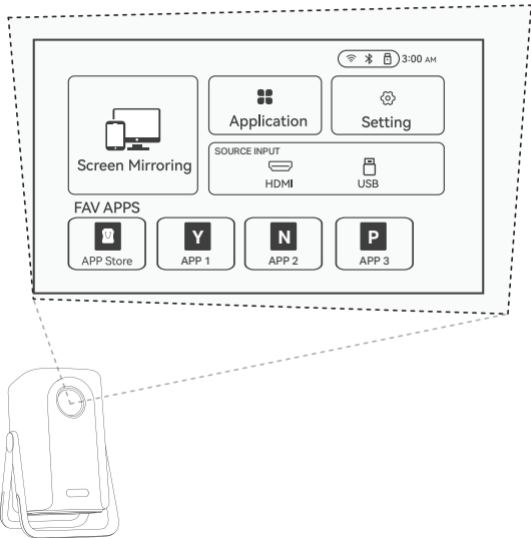

Presentation Mode

Users can configure the projection mode based on how and where the projector is mounted. To change the presentation mode, go to Settings > Projection > Projection Mode and select the desired option.

Listed below are the available modes:

- **Front Desktop:** Default mode for placing the projector on a flat surface in front of the screen.
- **Desktop:** Standard forward projection from a desktop position.
- **Front Ceiling:** Used when the projector is ceiling-mounted and positioned in front of the screen. The image is flipped vertically to appear correctly.
- **Rear Ceiling:** For ceiling-mounted setups behind a translucent screen. The image is flipped both horizontally and vertically to suit rear projection.

Language

Access language and input method settings via Settings > Language & Input.

1. **Language:** Select your preferred language from the list of supported options.
2. **Input Method:** Choose the default keyboard input method.
Available options include:
 - G-board
 - Google Input Settings
3. **Android Keyboard Settings:** Manage settings for installed input methods.

Date

Go to Settings > Date to configure the system date, time, and time zone through the projector's settings menu.

1. **Auto Settings:** Toggle this option to enable or disable automatic date and time configuration. When disabled, you can manually enter the date and time.

- **Date Set:** Manually select the current date using the on-screen date picker.
- **Time Set:** Manually enter the current time.

2. Time-zone Set: Choose your preferred time zone from the list provided. This ensures the system clock reflects the correct local time.

System

Go to **Settings > System** to manage firmware updates and restore the projector to factory settings when needed.

- **System Upgrade:** Use this menu to check for and install online or local updates.
- **Reset (Factory Restore):** Select this option to restore all settings to factory defaults.

Note:

Do not power off or operate the projector during the reset process. Please wait patiently until the restoration completes.

Applications

Go to **Settings > Application > Applications** to view the apps downloaded from the projector's app store. The boAt CineHead M1 comes with a basic set of preloaded applications.

These apps are ready to use without the need for any external streaming devices.

Note:

- *The compatibility of third-party apps may vary as they are managed independently by app publishers.*
- *App performance may vary depending on network strength and app updates. Ensure the projector is connected to a stable Wi-Fi network for optimal streaming experience.*

Other Settings

Go to Settings > Other Settings to configure basic system behaviour for input, power, shutdown timer, screen saver, and audio output.

- **Input Source Options:** Set HDMI or no default (Off) input when the projector starts. Choose whether the projector should automatically switch to HDMI input at startup or stay idle (off) without selecting any input source. For example, if you always use HDMI devices, you can set HDMI as the default input source.
- **Power Source Options:** Choose whether the projector stays in standby or direct i.e., powers on automatically when plugged in.
- **Scheduled Shut Down:** Automatically powers off the projector after 10, 20, 30, 60, 90, 120, 180, or 240 minutes.
- **Screen Saver Wait Time:** Activates the screen saver after 1, 5, or 10 minutes of inactivity (or set to Never).
- **Audio Output Device:** Select between automatic audio routing or output via HDMI_ARC.

System Info

Check device details.

Image and Audio Settings

Long press the Focus button on the remote control to access quick settings related to the image and audio.

1. Image Settings:

- **Picture Modes:** Standard, Film, Dynamic, Soft, Game, Customized
- **Colour Temperature Modes:** Warm, Cool, Nature, Customized

2. Audio Settings:

- **Sound Modes:** Standard, Movie, News, Sports, Music, Customized

MAINTENANCE

Unloading and Cleaning the Dust Filter

To maintain optimal airflow and cooling performance, the dust filter in the boAt CineHead M1 should be cleaned regularly. Follow the steps mentioned below to remove and clean the dust filters:

Dust Filter Removal and Cleaning Procedure

Step 1: Remove the Filter

- Locate the dust filter at the bottom of the projector.
- Slide the filter outward to remove it from the compartment.

Step 2: Clean the Filter

- Gently tap or brush off dust from the mesh surface.
- If heavily soiled, rinse the filter with clean water and allow it to dry completely.

Important: Always turn off and unplug the projector before performing any cleaning.

Step 3: Reinstall the Filter

- After cleaning and drying, align the filter with the bayonet mount on the bottom.
- Slide it back into position until securely fixed.

Regular cleaning is recommended every few weeks or as needed based on environmental conditions.

First step

Take out dust filter from the projector bottom

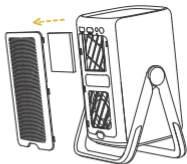

Second step

Clean the dust net

- ❶ For your safety, please cut off the power before cleaning



Third step

Align the bottom bayonet and install the dust filter



Dust Filter Removal and Cleaning Procedure

PRODUCT SPECIFICATIONS

Specification	Details
Model Name	CineHead M1
Imaging Technology	LCD
Native Resolution	1920×1080
Light Source	LED
Focus Mode	Automatic Focus
Projection Distance	1.2–5.3M
Screen Size	46–150 inches
Aspect Ratio	16:9 and 4:3 and Auto-fit
Power Input	100V~240V~50/60Hz
Ports	1 x USB, 1 x HDMI, 1 x AUX
Output	Earphone
Speaker	6 Watt
Net Weight	1.37 KG
Throw Ratio	1.16:1

FREQUENTLY ASKED QUESTIONS (FAQS)

Power is not turned on

After connecting the power cable to a working socket, wait for 5–10 seconds. The projector takes a short time to initialize before it can be powered on.

If it still does not turn on, check the power button and ensure the cable is securely inserted into both the projector and the wall outlet.

Power is suddenly turned off.

Check if the Scheduled Shut Down feature is enabled under Settings > Other Settings. If a timer (e.g., 30 or 60 minutes) is set, the projector will turn off automatically after the selected duration. You can disable or adjust this timer in the settings.

No image is displayed.

Check that the connecting cable is connected to the projector properly. Select the input source correctly.

Projected images are too dim.

Ensure the projector is used in a dark or pitch-black room for optimal visibility. Bright surroundings can significantly reduce perceived brightness. For best results, we recommend using the projector in a low-light or completely dark environment. Check if the room lighting is too bright. You can also try changing the Picture Mode via Quick Settings > Image Settings to "Dynamic" or "Game" for enhanced brightness.

The screen is blurry. What should I do?

Enable Auto Focus under Settings > Projection.

If needed, use Manual Focus with the remote's arrow keys. Ensure the projector is 1.2–5.3 m from the screen and the lens is clean.

The remote control isn't working. What should I check?

Ensure the batteries are correctly inserted and not drained. Replace with two fresh AAA 1.5V batteries. Make sure there's no obstruction between the remote and the projector's IR sensor.

Factory reset to default

Go to Settings > System and select Reset (Factory Restore). Wait until the process completes. Do not power off the projector during reset.

Can I connect the projector to my phone?

Yes. Use Screen Mirroring via Miracast for Android or AirPlay for iOS. Make sure both devices are on the same Wi-Fi network.

Does the projector support streaming apps?

Yes. The projector has pre-installed streaming applications. You can also install other applications through the App Store application. Please note that

the compatibility of the apps installed or Android TV / Android Stick connected to the HDMI port may vary.

Does CineHead M1 have sound?

Yes, it has built-in speakers. You can also connect Bluetooth speakers or earphones for louder sound.

Can I use CineHead M1 projector as a speaker?

Yes! Just connect your phone to the projector's Bluetooth and play music — it works like a speaker too.

There's no sound coming from the projector.

Try the following:

- Check if the volume is muted or set too low.
- Ensure the correct audio output is selected in the settings.
- If using external speakers, verify the connection.

SAFETY AND PRODUCT INFORMATION

To ensure safe use and prolong the life of your projector, please follow these warnings and safety guidelines:

REMOTE CONTROL PRECAUTIONS

- Handle the remote control carefully.
- If the remote control gets wet, wipe it dry immediately.
- Avoid excessive heat and humidity.
- Do not short, heat, or take apart battery.
- Do not throw battery into fire.
- If you will not be using the remote control for a long time, remove the battery.
- Dispose of used battery according to your local regulations.
- Do not place the battery upside down.

INSTALLATION

Do not place the projector under the following conditions:

- on an unstable cart, stand, or table.
- near water, baths, or damp rooms.
- in direct sunlight, near heaters, or heat radiating appliances.
- in a dusty, smoky or steamy environment.
- on a sheet of paper or cloth, rugs or carpets.

FIRE AND SHOCK PRECAUTIONS

- Ensure that there is sufficient ventilation and that vents are unobstructed to prevent the build-up of heat inside your projector.
- Allow at least 2 feet (approx. 60 cm) of space between your projector and a wall.
- Do not try to touch the ventilation outlet as it can become heated while the projector is turned on and immediately after the projector is turned off.
- Prevent foreign objects such as paper clips and bits of paper from falling into your projector. Do not attempt to retrieve any objects that might fall into your projector. Do not insert any metal objects such as a wire or screwdriver into your projector. If something should fall into your projector, disconnect it immediately and have the object removed by a qualified service personnel.
- Do not place any objects on top of the projector.
- Do not touch the power plug during a thunderstorm. Doing so can cause electrical shock or fire.
- The projector is designed to operate on a power supply of 100-240V AC 50/60 Hz. Ensure that your power supply fits this requirement before attempting to use your projector.
- Do not look into the lens while the projector is on. Serious damage to your

eyes could result.

- Keep any items (magnifying glass etc.) out of the light path of the projector. The light path being projected from the lens is extensive, therefore any kind of abnormal objects that can redirect light coming out of the lens, can cause unpredictable outcome such as a fire or injury to the eyes.
- Do not block the light path between the light source and the lens with any objects. Doing so could cause the object to catch on fire.
- Handle the power cord carefully. A damaged or frayed power cord can cause electric shock or fire.
 - Do not use any power cords other than the one supplied.
 - Do not bend or tug the power cord excessively.
 - Do not place the power cord under the projector, or any heavy object.
 - Do not cover the power cord with other soft materials such as rugs.
 - Do not heat the power cord.
 - Do not handle the power plug with wet hands.
- Turn off the projector, unplug the power cord and have the projector serviced by qualified service personnel under the following conditions:
 - When the power cord or plug is damaged or frayed.
 - If liquid has been spilled into the projector, or if it has been exposed to rain or water.
 - If the projector does not operate normally when you follow the instructions described in this user's manual.
 - If the projector has been dropped or the cabinet has been damaged.
 - If the projector exhibits a distinct change in performance, indicating a need for service.
- Disconnect the power cord and any other cables before carrying the projector.
- Turn off the projector and unplug the power cord if the projector is not to be used for an extended period of time.

WARNING

Do not place any objects which are easily affected by heat, in front of the projector lens. Doing so could lead to the object melting from the heat that is emitted from the light output.

WARRANTY

The boAt CineHead M1 comes with a 1-year domestic warranty from the date of purchase. For warranty support, visit <https://support.boat-lifestyle.com/>.

WEEE INFORMATION



This device and any electrical accessories are compliant with local applicable rules on the restriction of the use of certain hazardous substances in electrical and electronic equipment

Disclaimer:

Features may vary by product model. For detailed specifications, please refer to the product user guide.

Due to ongoing improvements, specifications are subject to change without prior notice. We continuously enhance our products to ensure the highest quality.

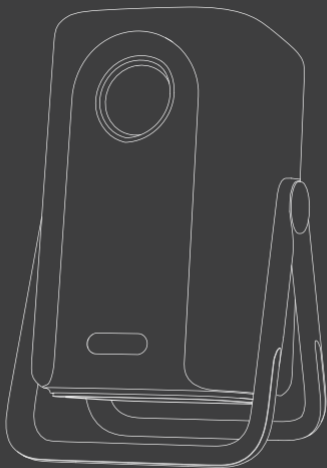

CINEHEAD M1