

**ENERGYSHROOM**  
**PB330 PRO MAGNACHARGE**



**USER MANUAL**



**ENERGYSHROOM PB330 PRO MAGNACHARGE**

Thank you for choosing the boAt EnergyShroom PB330 Pro MagnaCharge. This 10000mAh power bank is engineered for next-gen Qi2 magnetic wireless charging, 22.5W wired fast charging, and enhanced versatility with a built-in Type-C cable and Type-C 2-way port. The foldable aluminium stand allows hands-free use, while the strong magnetic surface ensures perfect alignment with Qi2-compatible devices. Packed with 12-layer Smart IC protection, it is built for safe, reliable, and travel-friendly power on the go.

**CONTENTS -**

- 1x EnergyShroom PB330 Pro MagnaCharge
- 1x Type-C Charging Cable
- 1x User Manual
- 1x Warranty Card
- 1x MagnaCharge Ring

**PRODUCT OVERVIEW -**

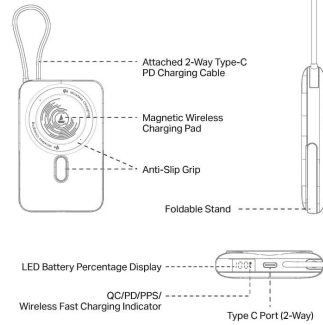

**FEATURES**

- 15W Qi2 Magnetic Wireless Charging: Supports next-gen Qi2 wireless charging with up to 15W (Max) output, ensuring strong magnetic alignment and efficient charging for compatible devices.
  - Dual Type-C 2-Way Fast Charging: Comes with 1x built-in Type-C (2-Way) cable + 1x Type-C (2-Way) port for both input and output. Charge or recharge using either of the two Type-C interfaces.
  - 22.5W Max Wired Fast Charging: Delivers up to 22.5W (Max) via both the Type-C cable and Type-C port with support for QC 3.0, PD, and PPS protocols.
  - LED Battery Percentage Display: Shows the remaining power level, helping you check the battery status anytime with ease.
  - 10000mAh High-Density Cell: Powered by a 10000mAh 3.85V (38.5Wh) lithium-ion polymer cell designed for efficiency and longer life cycles.
  - 12-Layer Smart IC Protection: Multi-level safety with protection from short-circuit, over-charge, over-discharge, and overheating.
  - Pass-Through Charging Support: Charge your devices while the power bank itself is being recharged, ideal for desks, travel, or overnight setups.
  - Compact, Durable & Travel-Friendly Design: Features an ultra-portable design with scratch resistance and high-temperature protection for everyday durability.
  - Free MagnaCharge Ring Included: Comes with a free MagnaCharge ring to make wireless charging smooth and perfectly aligned on non-MagSafe devices.
- Note: You can also use wired and wireless charging simultaneously.*

**LED FUNCTIONS**

- Press the power button once to switch the LED display on and see the charging status of the powerbank.
- The LED Display will turn on to indicate the battery status of the power bank.
- When your power bank or device uses QC 3.0, PD, PPS fast charging/discharging, or when Qi2 Wireless Fast Charging is active, the LED Display will show a green lightning icon next to the battery percentage.

**BUTTON FUNCTIONS**

- Press the power button once to switch on the Powerbank
- To switch off the Powerbank and turn the LED Display Off, press the power button twice.

**INSTALLING THE MAGNACHARGE RING**

- If your device does not have an inbuilt magnetic surface but supports wireless charging, you can attach the included Free MagnaCharge Ring to enable magnetic alignment.
- Remove the protective film from both sides of the ring. Then place the adhesive side directly over your device's wireless charging coil (refer to the image below). This is the same spot where your device charges wirelessly even without the ring.
- You may also apply the ring on your device's case, provided:
  - The case has a smooth PC/TPU surface
  - The case thickness is less than 4 mm
  - The surface is flat and clean before installation

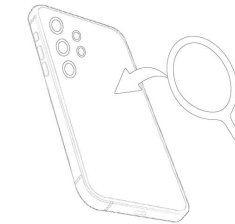

Front

**CHARGING ENERGYSHROOM PB330 PRO MAGNACHARGE**

- Connect the Type-C connector (built-in cable or Type-C port) to the Type-C port of the power bank to begin charging the PB330 Pro MagnaCharge.
  - Then, connect the other end of the Type-C connector to a compatible wall adaptor or laptop/computer USB Type-C port.
  - The LED percentage display will turn on to indicate charging progress. The display will show 100% when the power bank is fully charged.
  - If you are charging the power bank with a compatible QC 3.0, PD, or PPS fast charger, the LED display will show a green lightning icon next to the battery percentage.
- Note: Output from a computer's USB Type-C port is lower than a wall adaptor, so charging may take longer.*

**CHARGING YOUR DEVICES (WIRED)**

- Connect your device to the power bank using the built-in Type-C cable or the Type-C (2-Way) port, depending on your device's connector type.
  - If the power bank does not start charging automatically, single press the power button to begin charging.
  - If your device supports QC 3.0, Power Delivery or PPS fast charging, the LED Display will show a green lightning icon next to the battery percentage.
- Note: When using Pass-Through Charging (charging the power bank while it charges another device), the charging speed for both input and output may be slower.*

**Charging norms & Precautionary Guidelines: -**

- Fully charge your power bank before first use.
  - 1) Charger/Break/Adaptor: 3V/2A
  - 2) Cable/Wire: Standard Cable (35 strands @0.10mm diameter/strand)
- Any other accessory can be paired up with the product as long as the specifications are as per above norms.

**CHARGING YOUR DEVICES (WIRELESS)**

- To start wireless charging, place your phone centered on the Qi2 magnetic wireless charging surface. If your device has a magnetic surface (MagSafe/Qi2), it will attach to the magnet of the powerbank firmly when aligned correctly.
- If your device doesn't start charging, ensure it supports wireless charging. If it is compatible but still not charging, adjust the position on the pad until the charging icon appears on your device's screen.
- When 15W Qi2 Wireless Fast Charging, the LED display will show green lightning icon next to the battery percentage.

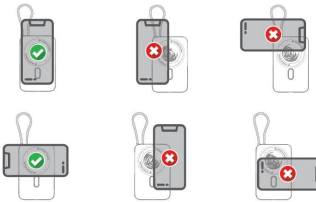

**CHARGING 2 DEVICES SIMULTANEOUSLY (WIRED + WIRELESS)**

- When charging two devices at the same time (one through wired charging and one through the wireless Qi2 surface), the charging speeds may reduce to maintain stable output.
  - 5W Wireless charging.
  - 5V Wired charging.
- Once either device is disconnected, the remaining device will switch back to fast charging automatically (QC 3.0 / PD / PPS for wired or Qi2 fast wireless).

**PRODUCT SPECIFICATION**

Capacity	10000mAh 3.85V (38.5Wh)
Rated Capacity	6700mAh (TYP 5V-2A)
Dimensions	111.3mm x 69mm x 40.63mm
Battery Type	Li-Ion polymer
Input	1x Type-C Cable (2-Way) 1x Type-C (2-Way)
Output	1x Type-C Cable (2-Way) 1x Type-C (2-Way)
Input 1 (Type-C)	5V=3A, 9V=2A
Input 2 (Type-C Cable)	5V=3A, 9V=2A
Output 1 (Type-C)	5V=3A, 9V=2.22A, 10V=2.25A, 12V=1.67A, 5-11V=2A PPS
Output 2 (Type-C Cable)	5V=3A, 9V=2.22A, 10V=2.25A, 12V=1.67A, 5-11V=2A PPS
Max Output (Wireless)	15W Qi2 (Max)
Max Output (Wired)	22.5W (Max)
Fully Charged by 9V/2A adaptor	3 Hours 20 min ± 10 Min
Fully Discharged by 18W load	1 Hours 45 Minutes ± 10
Operating Environment	-10 to 55° Celsius
Overcurrent Protection	3.40A ± 0.2A
Over Charging Voltage Protection	13.3V ± 0.2V
Short Circuit Protection	Available
Body Temperature Cut Off	55 to 60°C

**WEEE Information**

This device and any electrical accessories are compliant with local applicable rules on the restriction of the use of certain hazardous substances in electrical and electronic equipment

**IMPORTANT USER INSTRUCTIONS**

- Please utilize our standard Type C charging cable to charge the device.
- It is recommended to charge the power bank fully before its first use.
- Do not leave the power bank inside the car lying unattended.
- The product should be safeguarded against any physical shock or vibration.
- Keep out of the reach of children.
- If the power bank gets discharged completely, make sure to quickly put it into charge.
- Do not leave the battery on charge for over 24 hours.
- Charging current and voltage should not exceed the maximum specified amount.

**WARNING**

- Do not drop, decompose, impact the device or repair it on your own.
- Do not put this product in water, exposed to fire or direct sunlight.
- Do not use the product around combustible gas. It may catch fire and/or cause burns.
- Do not disassemble or attempt to replace the Li-polymer battery under any circumstance, as it may damage the device permanently.

**E- WASTE MANAGEMENT**

As per government rules, all E- wastes are to be managed by effective treatment under specialized methodologies prescribed by the Govt. of India. Do not dispose the product as unsorted municipal waste. The waste will be treated as per the norms set by the pollution control board. Please contact customer care for getting guidance on proper disposal of this product.



Back

*Disclaimer: Features may vary by product model. For detailed specifications, please refer to the product user guide. Due to ongoing improvements, specifications are subject to change without prior notice. We continually enhance our products to ensure the highest quality. This device and any electrical accessories are compliant with local applicable rules on the restriction of the use of certain hazardous substances in electrical & electronic equipment.*